

31" TOWER FAN

2300398 - Instruction Manual

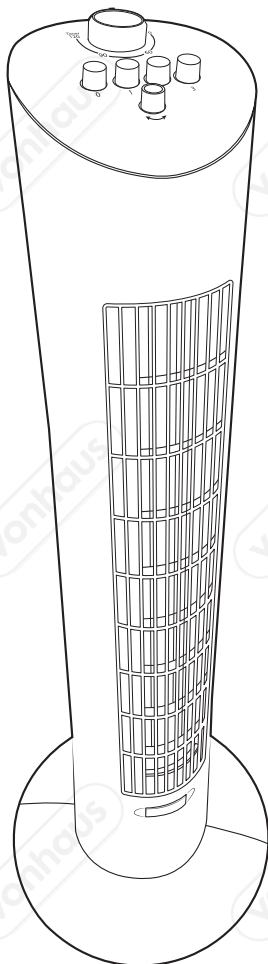

CONTENTS

Safety Instructions

1

Safety Instructions, Safety Symbols

2

Specification

3

Base Assembly, Controls

4

Using the Aroma Tray, Cleaning & Maintenance, Troubleshooting

5

Warranty

6

WARNING

PLEASE READ THESE INSTRUCTIONS CAREFULLY AND KEEP FOR FUTURE REFERENCE

INTENDED USE.

This VonHaus 31" Tower Fan is designed for light domestic use only. It is not intended for heavy duty, commercial or industrial use, and is not suitable for use outdoors.

This appliance is not intended for use by children or infirm persons without supervision. Extreme caution is necessary when used near children, and whenever the appliance is left operating unattended. Take adequate precautions if such persons are to be left alone in the vicinity of the appliance.

Use this appliance only as described in this manual. Any other use is not recommended by the manufacturer and may cause fire, electric shock or injury.

PRIOR TO USE.

Remove the packaging and make sure that the appliance is intact. If in doubt, do not use the appliance and contact DOMU Brands Customer Services.

Do not leave packaging materials such as bags and staples within reach of children. Dispose of packaging carefully and with consideration for the environment.

It is recommended that you retain the appliance box for seasonal storage. For your convenience, record the date you received the appliance on the 'Warranty' page of these instructions and attach your proof of purchase. Retain this information in the event that a warranty service is required.

SAFETY INFORMATION.

When using any electrically-powered appliance, basic safety precautions should always be followed to reduce the risk of fire, electrical shock, or injury to persons or property:

CABLES AND PLUGS.

Check to ensure your electricity supply matches that shown on the rating label of

the appliance. The appliance must only be used as rated.

Do not operate any appliance with a damaged cord or plug, or after the appliance malfunctions or has been dropped or damaged in any manner.

Return to a qualified electrical person for service and repair.

Do not connect the appliance to the mains voltage until completely assembled and adjusted.

Unroll the cord before operating.

Operating with a coiled cord may cause overheating and risk of fire.

The use of an extension cord with this appliance is not recommended.

Do not allow the cord to come into contact with the appliance surface during operation.

Do not run the cord under carpeting, mats or rugs etc. Arrange the cord away from traffic areas so that it will not be tripped over.

Do not twist, kink or wrap the cord around the appliance as this may cause the insulation to weaken and split.

Always unplug the appliance when not in use. Do not leave unattended.

Always switch off the appliance before unplugging from the power socket.

Always hold the plug when removing it from the wall, do not pull the cord.

CAUTION: In order to avoid a hazard due to inadvertent resetting of the thermal cut-out, this appliance must not be supplied through an external switching device, such as a timer, or connected to a circuit that is regularly switched on and off.

RISK OF PERSONAL INJURY.

Use this appliance only as described in this manual.

Do not use this appliance with any type of external timer.

WARNING

PLEASE READ THESE INSTRUCTIONS CAREFULLY AND KEEP FOR FUTURE REFERENCE

Always operate upright, on a flat surface only.

WARNING! DO NOT COVER.

Do not cover or restrict airflow to the inlet or outlet grilles in any manner.

To avoid overheating, keep airflow grilles clear of dust and hair build up, especially if you have indoor pets.

Do not cover grilles or block entry or exits of airflow by placing the appliance against any surface.

Keep all objects at least 1 metre from the front, side and rear of the appliance.

Do not insert or allow foreign objects or metal utensils into any ventilation or exhaust openings as this may cause an electric shock, fire or damage to the appliance.

Do not operate the appliance with wet hands.

Do not immerse in liquid or use the appliance near water as this could create an electrical shock hazard.

If the appliance accidentally comes into contact with water, switch off the power supply and do not touch the appliance. Never attempt to remove the cover of the appliance. Repairs requiring opening the appliance or access to internal parts must be carried out by a qualified electrician or repair service professional. There are no

user-serviceable parts of this appliance (excluding the plug fuse).

Before moving the appliance, switch it off by unplugging it from the wall and allowing it to cool.

POSITIONING YOUR FAN.

This appliance is designed to be placed on a hard, level surface. When positioning, please keep the following points in mind:

Do not locate in areas of high foot traffic.

To avoid accidents, always ensure that the power cord and appliance are in full view.

If you are placing the appliance in an alcove, make sure that there is at least 150mm of space on all sides to ensure good air circulation.

Do not fit the appliance in confined spaces such as cupboards or wardrobes.

Do not operate the appliance in bathrooms, laundry areas or similar moist indoor locations. Do not use in the immediate surroundings of a bath, shower or swimming pool.

The appliance must not be located immediately below or in front of a socket outlet.

The socket must always be accessible in order to disconnect the appliance from the electrical supply for maintenance.

SAFETY SYMBOLS

Please ensure you understand their meanings before operating this product in order to prevent personal injury and avoid damage to the appliance.



WARNING!

Pay attention to all safety and guidance



Read manual before use

SPECIFICATION

VOLTAGE

V
220-240V ~50Hz

TIMER

Hours
2

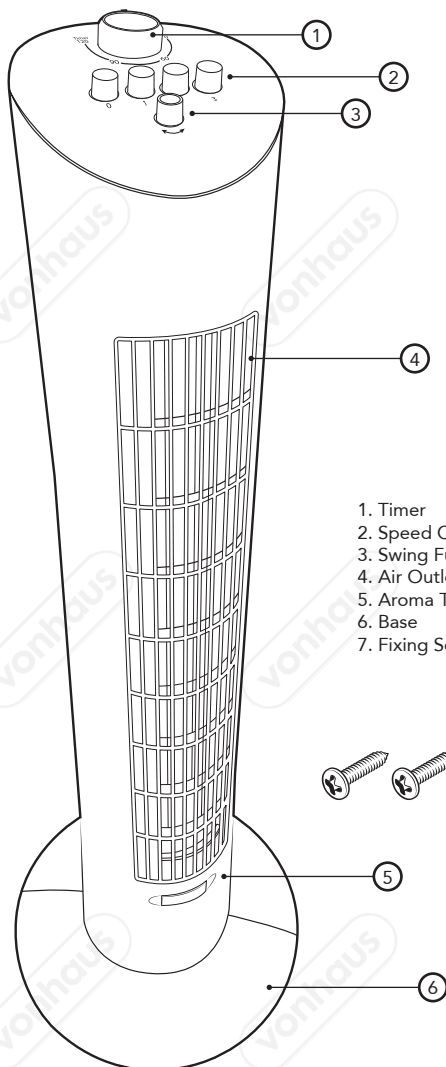

1. Timer
2. Speed Control
3. Swing Function
4. Air Outlet
5. Aroma Tray
6. Base
7. Fixing Screws x 4



BASE ASSEMBLY

1. Take the two sections of the base (4) and align pins on one with the holes in the other. Firmly press down to connect them securely.

IMPORTANT: Ensure you do not use excessive force as this may damage the Base.

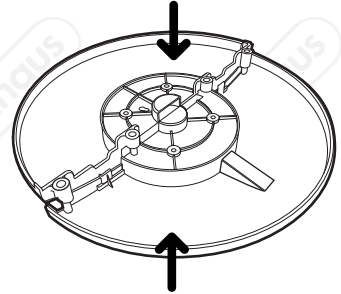

2. Invert the Main Unit (3) and align the assembled base with the 4 screw holes on the bottom of the Main Unit. Use the 4 Fixing Screws (6) supplied to attach the two together. Ensure the Base is completely secure before standing the Tower Fan in its upright position.

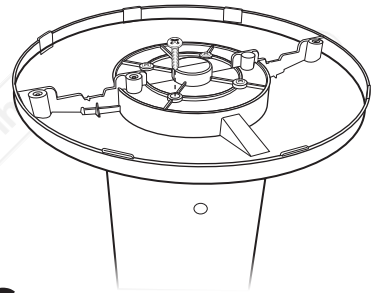

CONTROLS

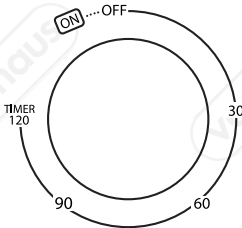

NOTE: Both the Timer and Speed control must be on for the product to operate.

TIMER: This can be set to up to 2 hours, when set the Tower Fan with switch off after the selected amount of time and expired.

NOTE: For continuous use of the Tower Fan set the dial to ON position.

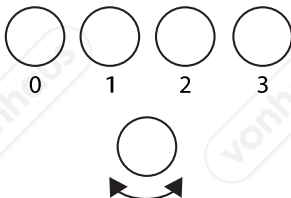

SPEED CONTROL:

0 = Off
1 = Low Speed
2 = Medium Speed
3 = High Speed

SWING: This sets the Tower fan to motion from left to right. Pressing again will stop the motion.

USING THE AROMA TRAY

NOTE Any additives to be used should only be used in the **AROMA TRAY (9)**.

Remove the **AROMA TRAY (9)** from bottom of the Tower Fan on the front of the unit by pulling to release it.

Carefully pipette your aroma fluid, additives, or medical lotions onto the sponge of the Aroma Tray and allow to settle into the foam before sliding the tray back into the unit.

To clean, remove the **AROMA TRAY (9)** from the base of the unit and rinse in warm soapy water.

Take care not to damage the sponge whilst cleaning.

IMPORTANT Allow the sponge to dry naturally and do not use until it is completely dry.

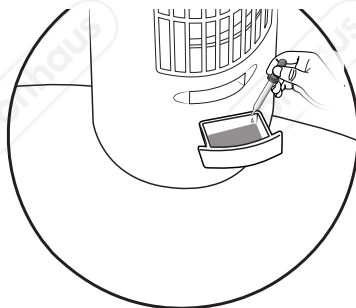

CLEANING & CARE

IMPORTANT: Turn off the Tower Fan before cleaning.

Vacuum-clean air vents and grilles to remove dust from these areas.

To remove dust on external surfaces, wipe the Tower Fan with a damp (not wet) lint-free cloth rinsed in hot soapy water only.

CAUTION: Do not use any harsh detergents or abrasive cleaners.

WARNING! Do not spray with any liquids or submerge in liquid or water.

WARNING! Do not attempt to clean the interior of the Fan. Do not attempt to open the casing at any time. There are no user-servicable parts.

TROUBLESHOOTING

PROBLEM	SOLUTION
THE FAN WILL NOT POWER ON	Ensure the Fan is switched on and connected to the mains power. Ensure the Base is fitted and the Fan is upright.
THE TOWER FAN BECOMES DAMAGED	Discontinue use and contact DOMU Brands Customer Services.

DISPOSAL INFORMATION

PRODUCT DISPOSAL INFORMATION

For electrical products sold within the European Community, at the end of the electrical product's useful life, it should not be disposed of with household waste. Please recycle where facilities exist.

Contact your local authority for details of collection schemes in your area.

In all circumstances:

- Do not dispose of in domestic waste.
- Do not incinerate.
- Do not abandon in the environment.
- Do not dispose of WEEE as unsorted municipal waste.

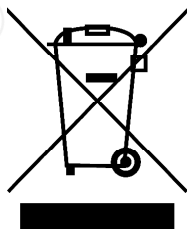

WARRANTY

To register your product and find out if you qualify for a free extended warranty, go to:

www.VonHaus.com/warranty

Please retain a proof of purchase receipt or statement as proof of the purchase date.

The warranty only applies if the product is used solely in the manner indicated in the Warnings page of this manual, and all other instructions have been followed accurately. Any abuse of the product or the manner in which it is used will invalidate the warranty.

Returned goods will not be accepted unless re-packaged in its original packaging and accompanied by a relevant and completed returns form. This does not affect your statutory rights.

No rights are given under this warranty to a person acquiring the appliance second-hand or for commercial or communal use.

COPYRIGHT

All material in this instruction manual are copyrighted by DOMU Brands Ltd.

Any unauthorized use may violate worldwide copyright, trademark, and other laws.

Thank you for purchasing the 31" Tower Fan.

VonHaus is a registered trademark of DOMU Brands Ltd
Made in China for DOMU Brands Ltd M24 2RW

VonHaus