

400W MINI CHOPPER

2000086 - Instruction Manual



CONTENTS

Safety Instructions	1
Safety Instructions	2
Specification	3
Before First Use, Assembly	4
Operation	5
Recommendations	6
Cleaning & Maintenance , Warranty	7

SAFETY INSTRUCTIONS



PLEASE READ THESE INSTRUCTIONS CAREFULLY AND KEEP FOR FUTURE REFERENCE.

INTENDED USE.

Only operate the VonShef® Mini Chopper for its intended purpose and within the parameters specified in this manual.

This appliance is for domestic use only. Do not use outdoors or on wet surfaces.

This appliance is not intended for use by persons with reduced physical, sensory or mental capabilities, or lack of experience and knowledge, unless supervised or given appropriate instruction concerning the product's use by a person responsible for their safety.

This machine is not intended for use by children.

GENERAL PRECAUTIONS.

When using an electrical appliance, basic precautions should always be followed, including the following:

Do not allow to be used as a toy. Children should be supervised to ensure they do not play with the Mini Chopper.

If the Mini Chopper is not functioning properly, has been dropped, damaged, left outdoors, or immersed in liquid, do not use, contact DOMU Brands Customer Services.

Do not use the Mini Chopper if any parts appear to be faulty, missing or damaged.

Ensure all parts are securely attached before use.

CABLES AND PLUGS.

Check to ensure your electricity supply matches that shown on the rating plate. This product should only be used as rated. Preferably, the socket outlet should be protected by a Residual Current Device (RCD).

Do not use with a damaged cable or plug. If the supply cable is damaged, it must be replaced by a qualified engineer or authorised service agent in order to avoid a hazard.

The use of an extension cable is not recommended.

Do not handle the plug or appliance with wet hands.

Keep the cable away from heated surfaces.

Do not let the cable hang over the edge of the table or countertop where it could be pulled on inadvertently by children or pets.

Do not pull the cable around sharp edges or corners.

Do not leave unattended when plugged in. Unplug from outlet when not in use.

Turn off all controls before unplugging.

Do not unplug by pulling on the cable. To unplug, grasp the plug, not the cable.

Always unplug before performing user maintenance, connecting or disconnecting attachments, or changing accessories.

Ensure the cable is stored safely to prevent hazards.

SAFETY INSTRUCTIONS



WARNING



PLEASE READ THESE INSTRUCTIONS CAREFULLY AND KEEP FOR FUTURE REFERENCE.

RISK OF PERSONAL INJURY.

Always locate your appliance away from the edge of the worktop, on a firm, flat, heat-resistant surface with sufficient space around all sides.

The Mini Chopper is not intended to be operated by means of an external timer or separate remote-control system.

Do not insert any objects into openings or cover the appliance.

Keep hair, loose clothing, fingers and all parts of body away from openings and moving parts.

Never operate the Mini Chopper when empty.

Do not overload the Mini Chopper.

When using for the first time your Mini Chopper may give off a 'new' smell or vapour. This will dissipate after a few uses.

Never attempt to remove food or liquid from the Bowl while the Blade is still moving. Always allow it to stop completely.

Do not lift or move the Mini Chopper whilst in use.

Do not operate continuously for periods longer than those marked on the product or indicated in the instructions.

Handle the Blade Rod/Blade with care when removing from the bowl.

Ensure the appliance is switched off and unplugged before changing accessories or cleaning.

Do not wash the Blade or Milkshake Attachment in a dishwasher as they are not dishwasher-safe.

Do not lubricate any parts or carry out any maintenance or repair work other than that shown in this manual, or as advised by the DOMU Brands Customer Care Helpline.

Use only as described in this manual and with DOMU Brands recommended attachments only.

TECHNICAL SPECIFICATION

VOLTAGE

V
220-240

RATED
POWER

W
400

RATED
FREQUENCY

Hz
50/60

PRODUCT SPECIFICATION

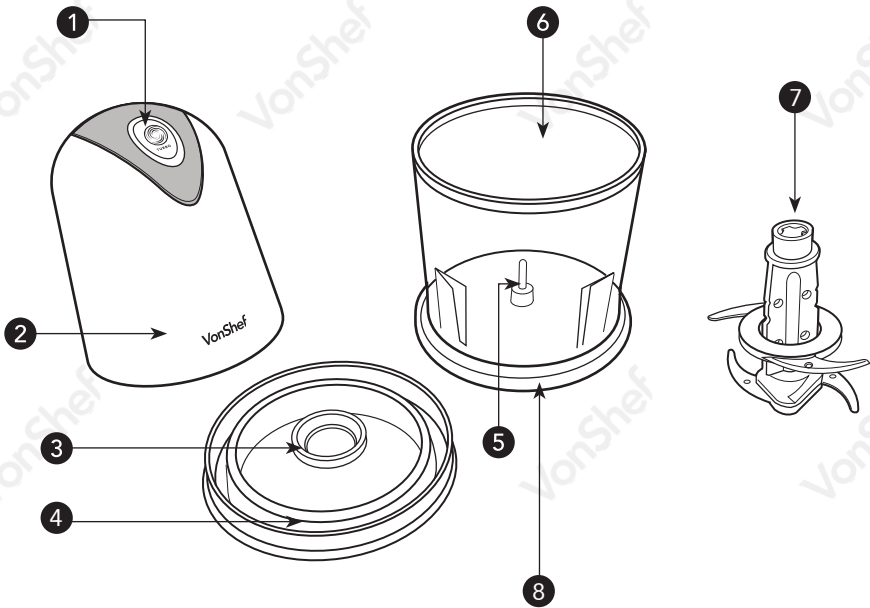

1. TURBO BUTTON.

2. MOTOR UNIT.

3. LID COLLAR.

4. LID.

5. BLADE ROD.

6. BOWL.

7. CHOPPING BLADE (designs may vary).

8. BOWL SUPPORT.

BEFORE FIRST USE

Before using this appliance for the first time, please ensure you complete the following steps:

- Carefully unpack the Mini Chopper and all parts. Remove all packaging materials, including any stickers or labels.
 - Clean the **BLADE ROD, BOWL, and LID** with a damp cloth or sponge. Wipe dry with a soft dry cloth.
 - Clean the **MOTOR UNIT** with a damp cloth or sponge.
- CAUTION:** Take extra care when washing the **BLADE ROD** as the **BLADE** is very sharp.
- WARNING!** Never immerse the Mini Chopper or cord in water or any other liquid.
- Position the Mini Chopper on a dry, level and heat-resistant surface.

ASSEMBLY

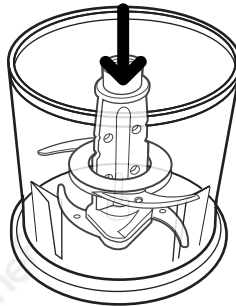

Insert the **CHOPPING BLADE** onto the **BLADE ROD** in the centre of the **BOWL**.

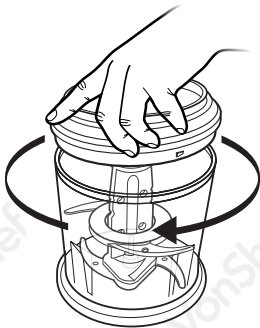

Once filled with ingredients, securely attached the **LID** to the top of the **BOWL**. Turn clockwise to lock into position.

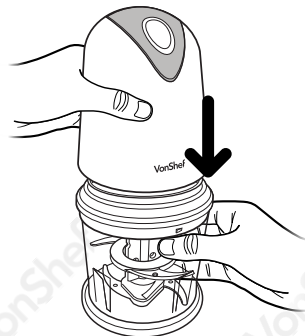

Connect the **MOTOR UNIT** to the **LID**. Ensure you align the peg in the centre before connecting to the mains outlet.

OPERATION

FOR CHOPPING OR MIXING INGREDIENTS

- Add your chosen ingredients to the **BOWL**, ensuring you do not overfill past the maximum marker.

TIP: We advise chopping up the ingredients slightly beforehand to minimise overall chopping time.



WARNING! Avoid adding ingredients that are too thick in consistency as these may slow down the **MOTOR UNIT** and could possibly damage the **BLADE**.

- Attach the **LID** as described on the previous page.
- Plug the appliance into a suitable plug socket.

NOTE: The Mini Chopper will not operate efficiently if the **MOTOR UNIT** has not been attached correctly to the **LID** or **BOWL**.

- Press down on the **MOTOR UNIT** to operate the Mini Chopper. If you wish to increase chopping power, simply press down the **TURBO BUTTON** at the same time.
- After use, unplug the appliance and wait for the **BLADE** to stop completely before removing the **MOTOR UNIT** and **LID**.
- Carefully remove the **BLADE** and gently shake off any chopped ingredients that may have stuck to it.

NOTE: The operation can be carried out three times with a resting period of **30 minutes**. **DO NOT** use for more than **1 minute** each time.

CHOPPING/MIXING RECOMMENDATIONS

FOOD	MAX QUANTITY	MAX SIZE	MAX TIME	RECOMMENDED SPEED
Almonds	100g	Whole	15 secs	TURBO
Boiled Eggs	200g	Cut half	10 secs	TURBO
Breadcrumbs	20g	20x20mm	15 secs	Low or TURBO
Garlic	150g	30x30mm	Pulse	TURBO
Ham	200g	20x20mm	15 secs	TURBO
Hazelnuts	100g	Whole	15 secs	TURBO
Ice Cream	200g	—————	20 secs	TURBO
Light Batter	0.4L	—————	15 secs	Low or TURBO
Onions	200g	30x30mm	Pulse	Low
Parsley	30g	Cut short	10 secs	Low or TURBO
Pepper	30g		30 secs	TURBO
Shallots	200g	30x30mm	Pulse	Low
Spice	0.2L	30x30mm	Pulse	TURBO
Soup	0.4L	—————	30 secs	TURBO
Steak	150-200g	20x20mm	15 secs	TURBO
Walnut	100g	Whole	15 secs	TURBO
Bread Dough	170g	—————	1 minute	TURBO

NOTE: If extra mixing is required, press the **TURBO BUTTON** at the same time for a **turbo boost**.

NOTE: When making milkshake with ice cubes, we recommend to firstly crush the ice cubes by using the **TURBO BUTTON** function for around **20 seconds** before adding milk and any other ingredients. Mix again until desired consistency is achieved.

NOTE: The operation can be carried out three times with a resting period of **30 minutes**.

CLEANING & MAINTENANCE

CAUTION: Before carrying out cleaning or maintenance, disconnect the appliance from the mains.

- Unplug the appliance and remove the **MOTOR UNIT, LID** and **BOWL**.
- Remove the **BLADE** from the **BOWL**.



WARNING! Take extra care when removing and cleaning the **BLADE ROD** as the **BLADE** is very sharp. We recommend using a scrubbing brush to avoid contact with the **BLADE**.

- Rinse the **BOWL LID, BOWL** and the accessories under warm running water. Scrub gently with a sponge and mild detergent.
- To clean the **MOTOR UNIT**, wipe down with a damp cloth.
- Dry the **MOTOR UNIT** and accessories with a soft dry cloth.



WARNING! Never immerse the **MOTOR UNIT** in water or any other liquid.

CAUTION: This appliance is **NOT** dishwasher-safe.

- Store in a dry place out of reach of children.

CUSTOMER SERVICES

If you are having difficulty using your product and require support, please contact hello@domu.co.uk

DISPOSAL INFORMATION

Please recycle where facilities exist. Check with your local authority for recycling advice.

WARRANTY

To register your product and find out if you qualify for a free extended warranty, go to:

www.VonShef.com/warranty

Please retain a proof of purchase receipt or statement as proof of the purchase date.

The warranty only applies if the product is used solely in the manner indicated in this manual and all instructions have been followed accurately. Any abuse of the product or the manner in which it is used will invalidate the warranty.

Returned goods will not be accepted unless re-packaged in its original packaging and accompanied by a relevant and completed returns form. This does not affect your statutory rights.

No rights are given under this warranty to a person acquiring this appliance second-hand or for commercial or communal use.

COPYRIGHT

All material in this instruction manual are copyrighted by DOMU Brands Ltd.

Any unauthorised use may violate worldwide copyright, trademark, and other laws.

Thank you for purchasing the Mini Chopper.

VonShef® is a registered trademark of DOMU Brands Ltd
Made in China for DOMU Brands Ltd M24 2RW.
